

# LEO

COMPONENT SPEAKERS

## LEO 650C



Installtion Instnkting

ITALY  
www.gttrading.it  
info@gttrading.it

## Surface mounting option

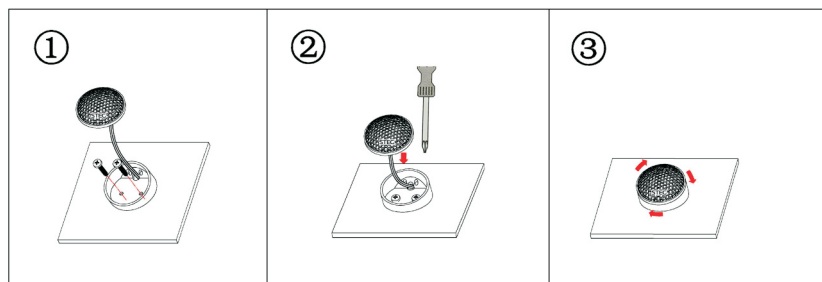

## Flush mounting for 50mm cutout

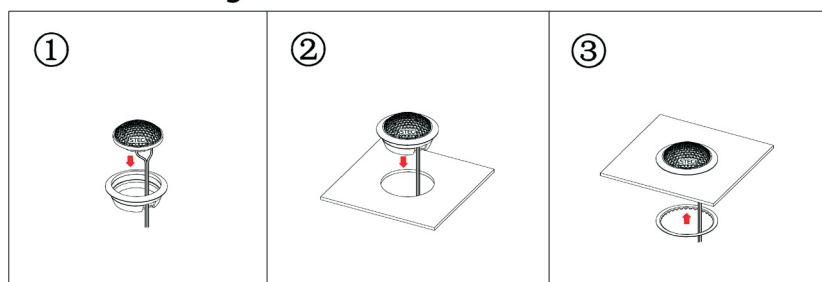

Specifications		
2-Way System		LEO 650C
Nominal Impedance		4 ohm
Power Handling		60W
Max.Transient Handling		120W
Sensitivity(2.83V/1M)		89dB
Frequency Response		65-20000Hz
Voice Coil Diameter	Woofer:	25mm(1")
	Tweeter	25mm(1")
Voice Coil Wire		Copper
Magnet System	Woofer:	High grade ferrite magnet
	Tweeter	neodymium
Mounting Depth		65mm

